

Filtre automatique FI114A
Instructions de montage et d'entretien

Automatic filter FI114A
Operating and maintenance instructions



Filtre automatique FI114A

Instructions de montage et d'entretien

1. Raccordement de l'évacuation

A. Evacuation à section réduite

Cas où l'évacuation se fait vers un tuyau de petit diamètre (inférieur à 100 mm).

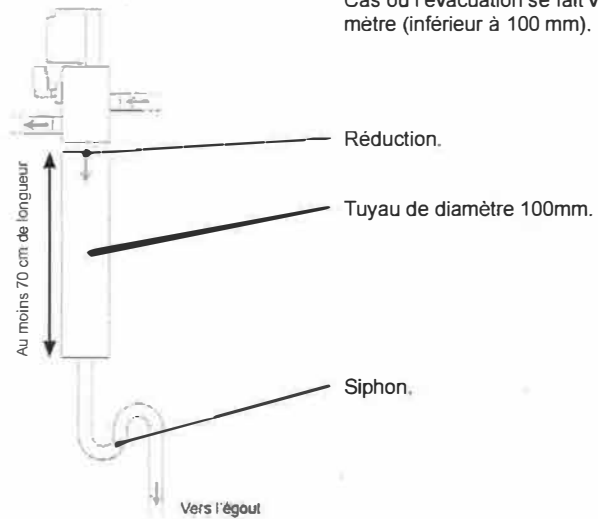

B. Evacuation 100 mm

Cas où l'évacuation se fait vers un tuyau de gros diamètre (au moins 100 mm).

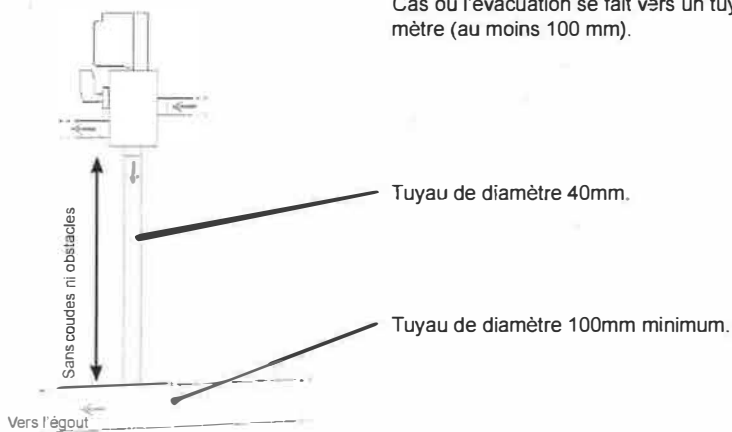

4. Maintenance

Filter screen replacement

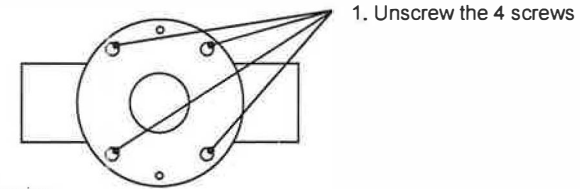
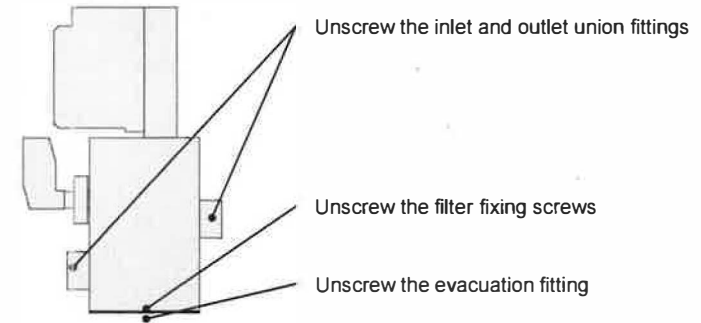

Bottom view

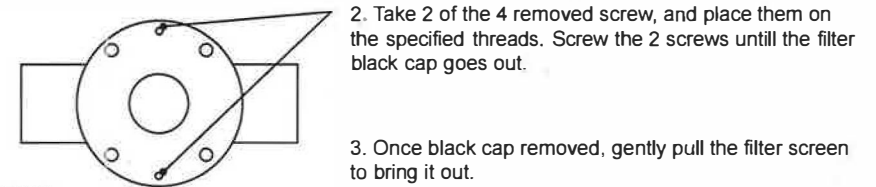

Bottom view

2. How to connect clean water outlet

A. flow rate below 3 m³/h and open air outlet

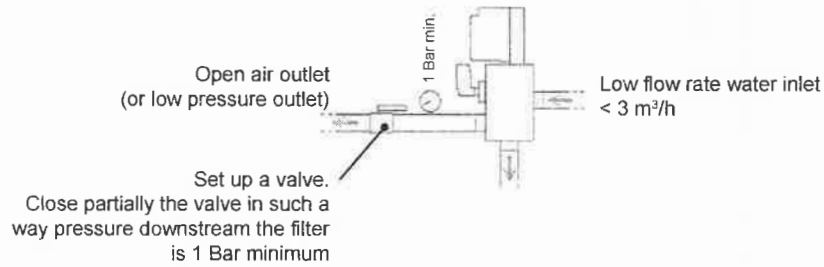

B. other cases

No back-pressure requirement.

3. Mounting

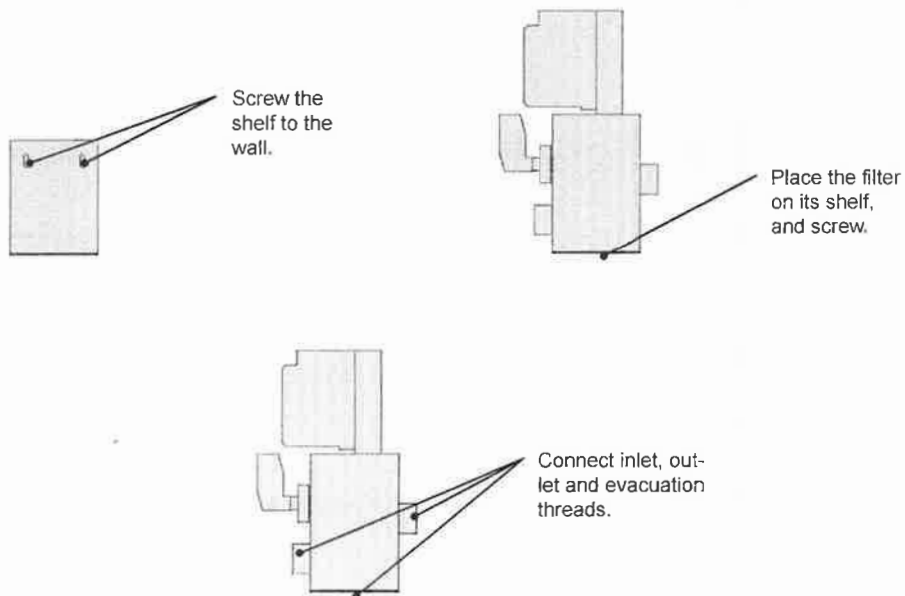

2. Raccordement de la sortie eau propre

A. débit inférieur à 3 m³/h et sortie à l'air libre

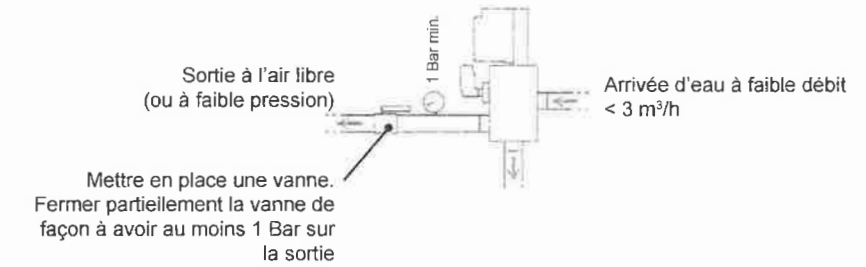

B. autres cas

Pas de contrainte de contre-pression.

3. Montage

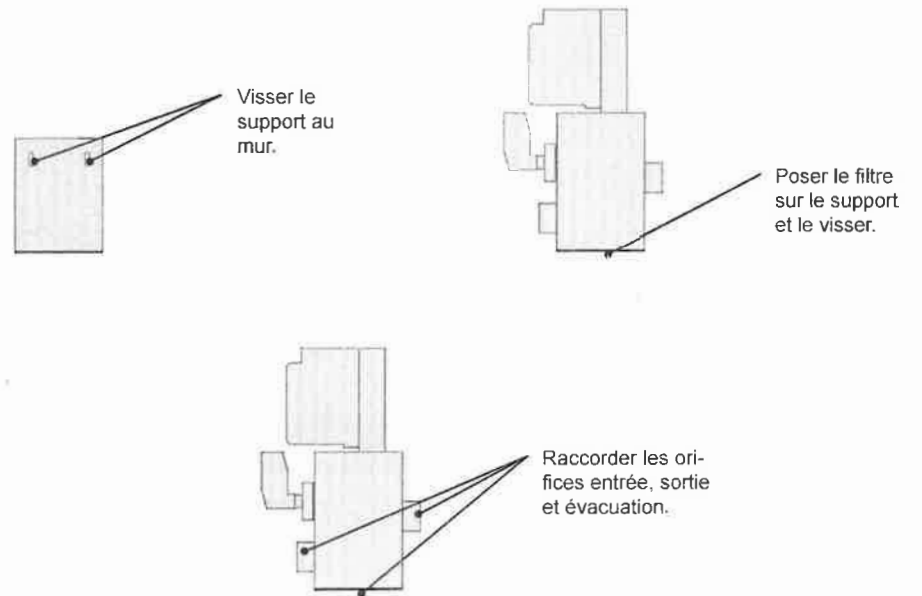

4. Maintenance

Remplacement du tamis filtrant

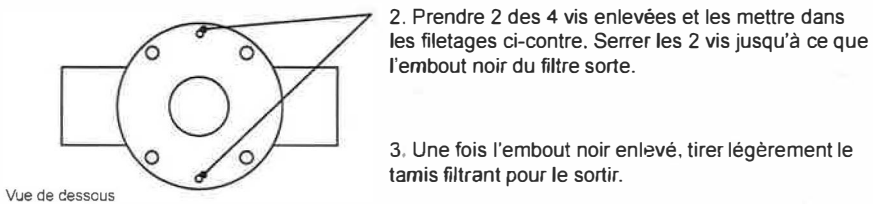
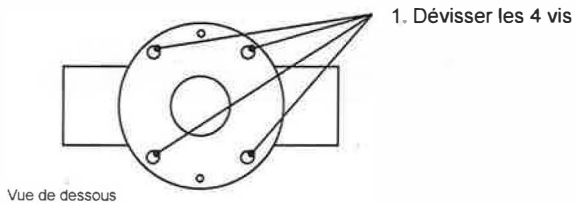
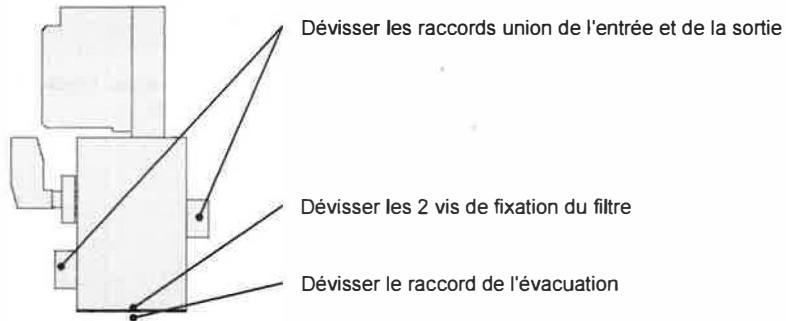

Automatic filter FI114A Operating and maintenance instructions

1. How to connect evacuation

A. Evacuation with reduced diameter

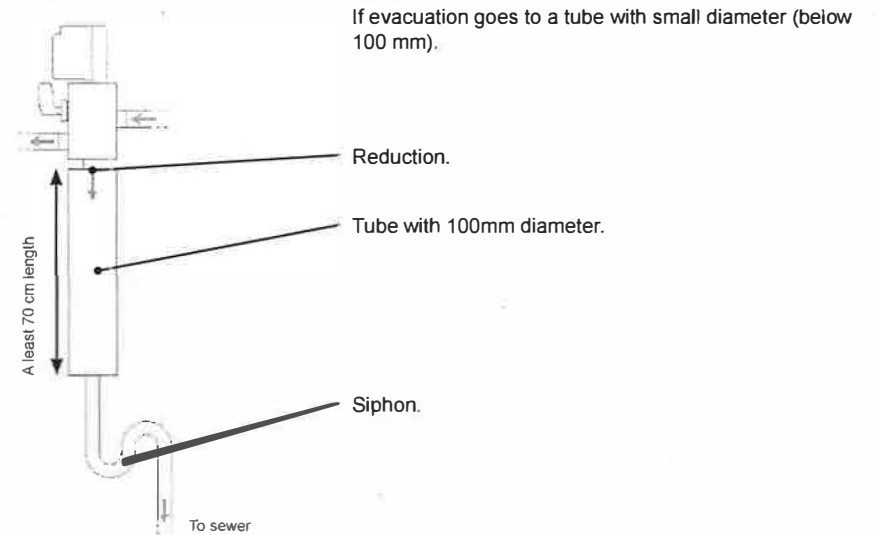

B. Evacuation with 100 mm diameter

